

Detachable type with remote control
HD407V-CR

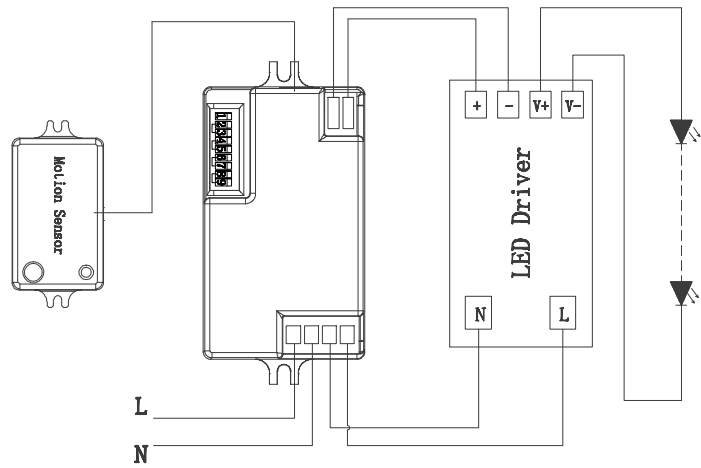

Wiring diagram

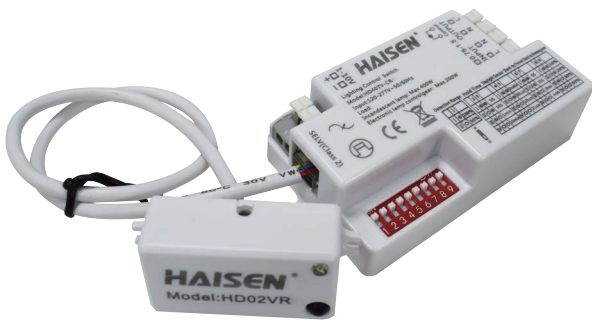

On/off control



Stand-by period



Detection area



Stand-by dimming level



Hold-time



Remote control setting



Daylight sensor



5 years

01 Technical data

Operating voltage	120~277 VAC 50/60Hz
Switching capacity	Max.200W(Control gear) Max.400W(Incandescent lamp)
Standby power	<1W
Detection area	50%/100%
Hold-time	5s/30s/1min/10min
Daylight threshold	2Lux/10Lux/50Lux Disable
Stand-by period	0s/30s/20min/+∞
Stand-by dimming level	10%/20%/30%/50%
Microwave frequency	5.8GHz ± 75MHz
Microwave power	<0.3mW
Interfaces	6-pole pluggable clamp terminal (L,N,N,L',1-10v+,1-10v-)for 0.75- 1.5mm ² cable
Mounting height	Max.6m(ceiling mounted)
Detection range	Max.14x6m(ceiling mounted) Max.10m(wall mounted)
Operating temperature	-20°C~+55°C
IP rating	IP20

Note: Motion sensor setting and dimming setting please refer to remote control HD02R.
HD02VR Standard Version Cable Length 30mm(can be customized).

02 Mechanical structure(mm)

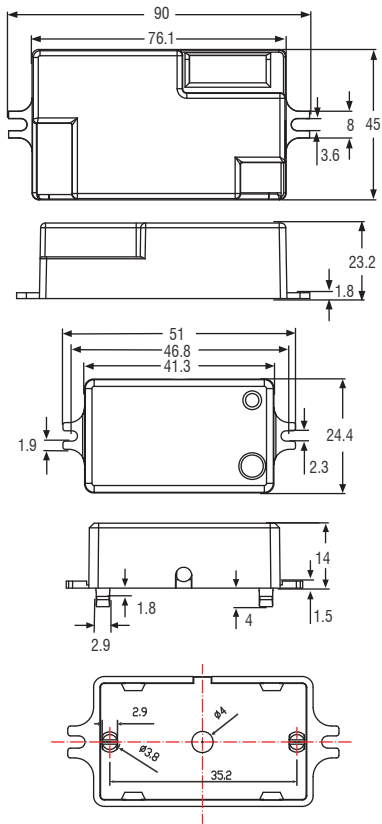

03 Settings

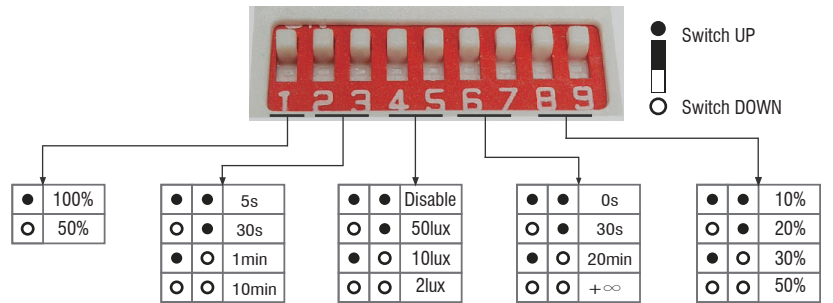

- Detection area**
 Detection area means detection coverage. It can be adjusted by combining DIP switches for specific application.
- Hold-time**
 Hold-time means the time period the light will be ON after the last detection.
- Daylight threshold**
 Daylight sensor prioritizes motion sensor. Set threshold for specific needs. If Disable, only motion sensor works.
- Stand-by period**
 This is the time period the light keeps dimming down after the last detection.
- Stand-by dimming level**
 This is the dimming level the light keeps during stand-by period.

04 Detection coverage

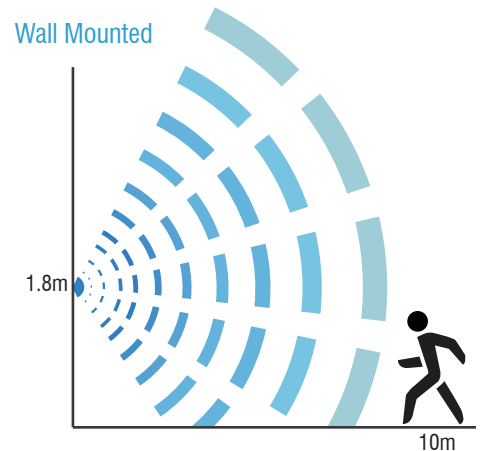
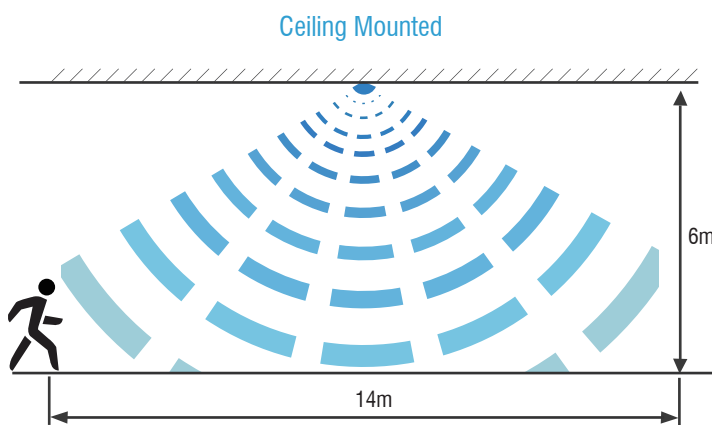

05 Application

Function Demo - Dimmable control/Corridor function

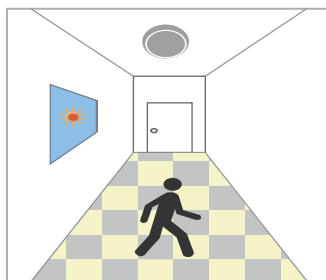

With sufficient daylight, even when motion detected, light remains OFF.



With insufficient daylight, when motion detected, light ON.

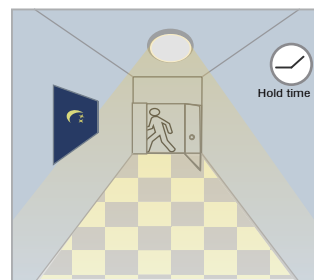

After last detection, the light will be dimmed down to the stand-by dimming level (10%, 20%, 30% or 50%) after holdtime.

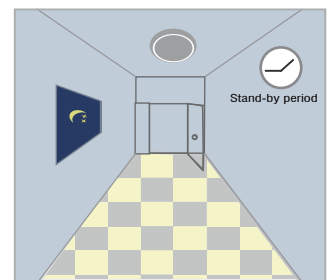

After the stand-by period, light OFF.