



PRODUCT OVERVIEW

ETi SSL's full cutoff design maximizes light distribution and application spacing while **eliminating uplight**. It features three selectable CCTs and three selectable wattages—offering flexibility and efficiency.

Equipped with 0-10V dimming, universal 120-277 voltage, and Dusk-to-Dawn Photocell with enable/disable capability, this wall pack is ideal for security lighting around building perimeters and other applications where minimized light pollution is desired.



**3 LUMEN
BOOST®**



INNOVATE. ILLUMINATE. INSPIRE.

FULL CUTOFF LED WALL PACK | 3 LUMEN BOOST® | 3 CCT COLOR PREFERENCE®

Scan code
for more
information



PERFORMANCE SUMMARY				
Lumen Packages	Lumen Pkg. Range (LB3)	Selectable Watt. Levels	CCT (CP3)	Distribution
Lumen Pkg 1	4000 – 8000	20 40 60	3000K 4000K 5000K	 TYPE IV
Lumen Pkg 2	9000 – 14000	60 80 100	3000K 4000K 5000K	

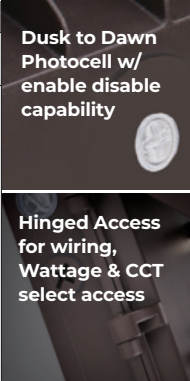

Dusk to Dawn
Photocell w/
enable/disable
capability

Hinged Access
for wiring,
Wattage & CCT
select access



ELECTRICAL DATA	
Operation: 120-277V, 50/60Hz	
Low Temp Start / Max Temp: -40° C (-40 F) / 50° C (122° F)	
Controls: 0-10V, Photocell Dusk-to-Dawn	
CERTIFICATIONS & OTHER INFO	
Warranty: 5 year	
UL/cUL Listed: Wet location, IP65 Rated	

Removable heatsink allows for easier mount and install.

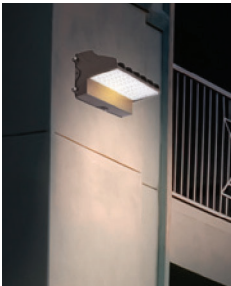
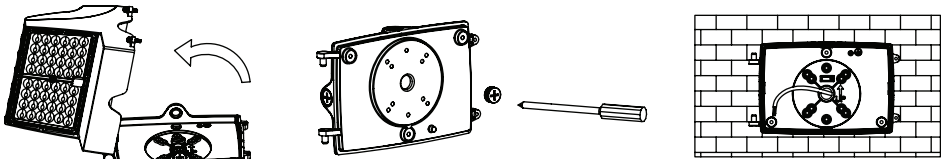

Dark Sky Compatible*
Full Cutoff Wall Pack can be
utilized in dark sky compliant
plans when set to 3000K.

MTO OPTIONS

Full Cutoff Wall Packs are also
available with installed 8W
Battery Backup.