



PRODUCT OVERVIEW

ETI Lighting's 7" Spin Light® with PIR Motion Sensor has an E26 base and features a convenient design and flexibility for a variety of residential spaces. These integrated LED lights have **3 Color Preference®** field-selectable CCT options and a soft, comfortable light quality. They are 80+CRI and last 160,000 hours (L70).

Description: Integrated LED with PIR Motion Sensor

Motion Detection: up to 13' away, up to a 10' mounting height

Maximum Sensing Angle: 100°

Length: 7", Width: 7", Height: 3.58", Weight: 0.8 lb

Integrated LED: 10.5w, 830 lm

Long Life: 160,000 hr projected life (L70)

3 CCT: 3000K, 4000K, 5000K | CRI: 80+

-4°F and +104°F (-20° C and +40° C).

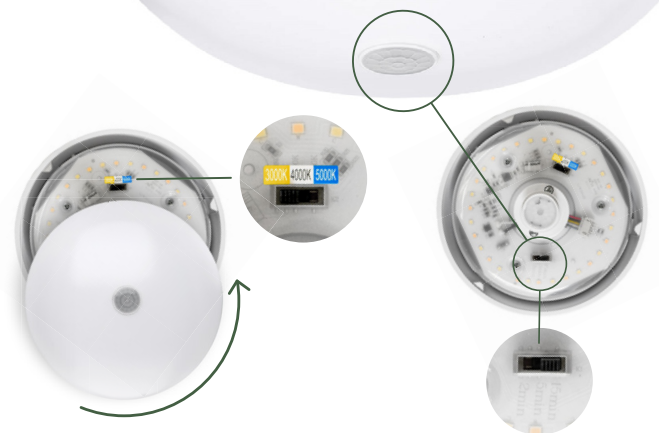

Twist-off lens gives easy access to color temperature select switch and PIR Motion Sensor control switch.

Integrated PIR Motion Sensor

3 Hold Times:
2 min | 5 min | 15 min

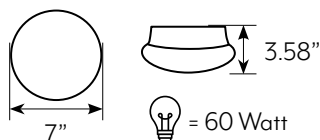

SpeedMount™ Kit included

SpinLight®

3 Color Preference®



Twists into existing lamp holder, just like a light bulb

