

DATE:	PROJECT:
TYPE:	NOTES:
CATALOG #:	

SLVT | SELLADO VAPOR TIGHT SERIES

3 LUMEN BOOST® | 3 CCT COLOR PREFERENCE®

KEY FEATURES

ETI's Sellado Vapor Tight Series is designed with a robust polycarbonate housing and durable stainless-steel latches to prevent moisture and dirt from compromising the housing and damaging internal wiring and components. Vapor Tights are weatherproof and rated IP65 to protect against dust and hose-down applications.

CCT & Light Quality

- Luminaire uses ETI's patented Color Preference® with 3 Selectable CCTs Standard (3500K, 4000K, 5000K)

Light Output & Efficacy

- 3 Lumen Boost and Wattage Levels:

2': 2600 | 3250 | 3900 lm 4': 3250 | 4875 | 6500 lm 8': 7800 | 9750 | 11700 lm
 20 | 25 | 30W 25 | 30 | 50W 60 | 75 | 90W

Dimming, Controls

- 0-10V Dimming
- Occupancy Sensor Options Available
- Battery Backup Options Available (4' and 8' only)

SPECIFICATIONS

Construction

- Gray polycarbonate corrosion-resistant housing with stainless steel latches
- Airtight seal prevents moisture and dirt from compromising the housing and damaging interior wires and components

Optics

- Non-yellowing high-impact resistant polycarbonate lens
- Frosted diffuser delivers even illumination and diminished glare

Installation

- Suspension and surface mounting kits included
- 3 LUMEN BOOST® / 3 CCT COLOR PREFERENCE® for easy field-adjustable lumen / CCT selection with switch located underneath the lens. Factory set to highest wattage and 3500K.

Electrical

- >175,000 hour LEDs at L70 for reduced maintenance
- Operates at 120-277V, 50/60 Hz
- 0-10V dimmable driver
- Temperature range: -4°F to 104°F (-20°C to 40°C)

Warranty

5-Year Standard Warranty. See terms at: ETISSL.com/warranty/

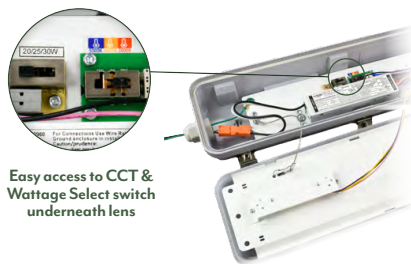

Easy access to CCT & Wattage Select switch underneath lens



Certifications & Test Data

- C/US ETL Rated
- UL Wet Location
- IP65, NEMA 4X
- NSF/ANSI 2 Listed
- Adheres to LM79, LM80, and TM21 industry standards for photometric, lumen maintenance and lifetime calculations
- DLC® Listed (DesignLights Consortium). Please refer to DLC for specific product qualifications at www.designlights.org (Search by part number, example: SLVT-4-LB3-8CP3-MV-LVD)
- Driver rated for FCC part 15 Class B for use in residential or commercial applications
- Impact Rating: IK08

KEY DATA	
LUMEN RANGE	2619 – 12404
WATTAGE RANGE	20 – 90
EFFICACY RANGE (LPW)	137 – 151 (BASED ON 4000K)
REPORTED LIFE (HOURS)	L70 / > 175,000



CATALOG LOGIC

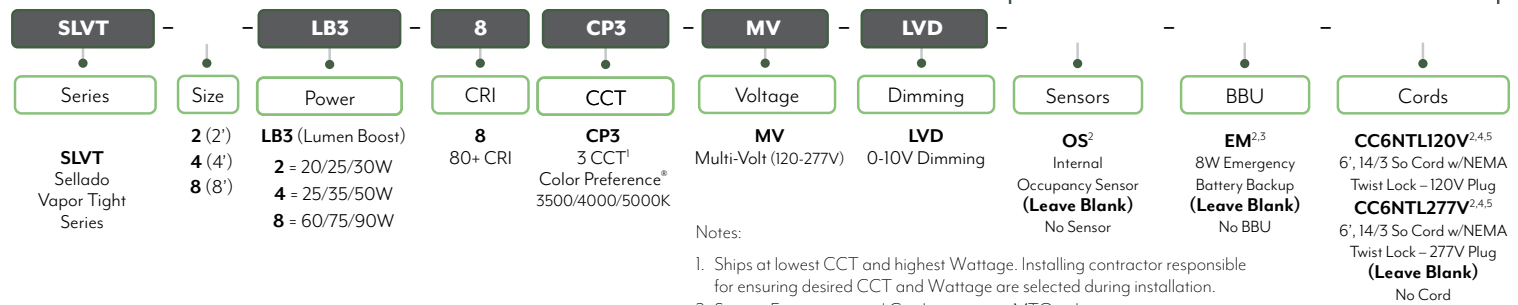

ORDER INFORMATION / SPEC DETAILS

	CATALOG PART NUMBER	ORDER NUMBER	DESCRIPTION	VOLTAGE	DIMMING	DLC	CRI	CCT	NOMINAL WATTS	DELIVERED LUMENS	EFFICACY																
2-FT	SLVT-2-LB3-8CP3-MV-LVD	64507101	Sellado Series 2' Vapor Tight	120-277V	0-10V	Standard	80+	3500K	20	2619	132																
									25	3300	132																
									30	4191	134																
								4-FT	SLVT-4-LB3-8CP3-MV-LVD	64508101	Sellado Series 4' Vapor Tight	120-277V	0-10V	Standard	80+	3500K	20	2680	137								
																	25	3481	145								
																	30	4365	144								
																8-FT	SLVT-8-LB3-8CP3-MV-LVD	64509101	Sellado Series 8' Vapor Tight	120-277V	0-10V	Standard	80+	4000K	20	2834	142
																									25	3421	140
																									30	4264	137
4-FT	SLVT-4-LB3-8CP3-MV-LVD	64508101	Sellado Series 4' Vapor Tight	120-277V	0-10V	Standard	80+	5000K	25	3428	144																
									35	4779	140																
									50	6669	133																
								8-FT	SLVT-8-LB3-8CP3-MV-LVD	64509101	Sellado Series 8' Vapor Tight	120-277V	0-10V	Standard	80+	4000K	25	3523	151								
																	35	4925	148								
																	50	7008	142								
8-FT	SLVT-8-LB3-8CP3-MV-LVD	64509101	Sellado Series 8' Vapor Tight	120-277V	0-10V	Standard	80+									5000K	25	3561	149								
																	35	4926	145								
																	50	6927	139								
								2-FT	SLVT-2-LB3-8CP3-MV-LVD	64507101	Sellado Series 2' Vapor Tight	120-277V	0-10V	Standard	80+	3500K	60	8617	137								
																	75	10080	134								
																	90	11742	131								
4-FT	SLVT-4-LB3-8CP3-MV-LVD	64508101	Sellado Series 4' Vapor Tight	120-277V	0-10V	Standard	80+									4000K	60	8711	144								
																	75	10359	143								
																	90	12404	140								
8-FT	SLVT-8-LB3-8CP3-MV-LVD	64509101	Sellado Series 8' Vapor Tight	120-277V	0-10V	Standard	80+	5000K	60	8500	139																
									75	10093	135																
									90	11834	132																

MTO MOTION SENSOR OPTIONS^{1,2} (Longer lead times apply)

Catalog Part Number	Order Number	Description
SLVT-2-LB3-8CP3-MV-LVD-OS	64507101-I	Sellado Series 2' Vapor Tight with Integral Motion Sensor
SLVT-4-LB3-8CP3-MV-LVD-OS	64508101-I	Sellado Series 4' Vapor Tight with Integral Motion Sensor
SLVT-8-LB3-8CP3-MV-LVD-OS	64509101-I	Sellado Series 8' Vapor Tight with Integral Motion Sensor

Notes: 1. Must order (70236101 / SLVT-RCOP) Sellado Series Vapor Tight Remote Control Occupancy Programmer accessory in order to change factory settings.
 2. Occupancy Sensor Default setting; 100% sensitivity, 5 min. hold time, Daylight sensor is ON, Dimming level: 30%, Dimming time: 60 minutes

MTO BBU OPTIONS (Longer lead times apply)

Catalog Part Number	Order Number	Description
SLVT-4-LB3-8CP3-MV-LVD-EM	64508101-EM	Sellado Series 4' Vapor Tight with 8W Emergency BBU
SLVT-8-LB3-8CP3-MV-LVD-EM	64509101-EM	Sellado Series 8' Vapor Tight with 8W Emergency BBU



ETI Lighting
 720 Northgate Parkway, Wheeling, IL 60090 | TEL: 1.855.384.7754
 E-mail: ETIorders@ETISSL.com | ETISSL.com

All specifications are subject to change without notice.
 All reported values are typical values, measured under laboratory conditions @ 25° C (77° F).
 Actual performance can vary slightly as a result of end-user application & environment.
 SLVT_VaportTight_SpecSheet | Page 2 of 4 | November 21, 2024

MTO MOTION SENSOR + BBU OPTIONS^{1,2} (Longer lead times apply)

Catalog Part Number	Order Number	Description
SLVT-4-LB3-8CP3-MV-LVD-OS-EM	64508101-I-EM	Sellado Series 4' Vapor Tight with Integral Motion Sensor and 8W Emergency BBU
SLVT-8-LB3-8CP3-MV-LVD-OS-EM	64509101-I-EM	Sellado Series 8' Vapor Tight with Integral Motion Sensor and 8W Emergency BBU

Notes: 1. Must order (70236101 /SLVT-RCOP) Sellado Series Vapor Tight Remote Control Occupancy Programmer accessory in order to change factory settings.
 2. Occupancy Sensor Default setting; 100% sensitivity, 5 min. hold time, Daylight sensor is ON, Dimming level: 30%, Dimming time: 60 minutes

MTO 6' 14/3 SO CORD W/NEMA TWIST LOCK PLUG (Longer lead times apply)

Catalog Part Number	Order Number	Description
SLVT-2-LB3-8CP3-MV-LVD-CC6NTL120V	64507201	Sellado Series 2' Vapor Tight with 6', 14/3 So Cord w/NEMA Twist Lock 120V Plug
SLVT-4-LB3-8CP3-MV-LVD-CC6NTL120V	64508201	Sellado Series 4' Vapor Tight with 6', 14/3 So Cord w/NEMA Twist Lock 120V Plug
SLVT-8-LB3-8CP3-MV-LVD-CC6NTL120V	64509201	Sellado Series 8' Vapor Tight with 6', 14/3 So Cord w/NEMA Twist Lock 120V Plug
SLVT-2-LB3-8CP3-MV-LVD-CC6NTL277V	64507301	Sellado Series 2' Vapor Tight with 6', 14/3 So Cord w/NEMA Twist Lock 277V Plug
SLVT-4-LB3-8CP3-MV-LVD-CC6NTL277V	64508301	Sellado Series 4' Vapor Tight with 6', 14/3 So Cord w/NEMA Twist Lock 277V Plug
SLVT-8-LB3-8CP3-MV-LVD-CC6NTL277V	64509301	Sellado Series 8' Vapor Tight with 6', 14/3 So Cord w/NEMA Twist Lock 277V Plug

MTO 6' 14/3 SO CORD W/NEMA TWIST LOCK PLUG + MOTION SENSOR^{1,2} (Longer lead times apply)

Catalog Part Number	Order Number	Description
SLVT-2-LB3-8CP3-MV-LVD-OS-CC6NTL120V	64507201-I	Sellado Series 2' Vapor Tight with 6', 14/3 So Cord w/NEMA Twist Lock 120V Plug and Integral Motion Sensor
SLVT-4-LB3-8CP3-MV-LVD-OS-CC6NTL120V	64508201-I	Sellado Series 4' Vapor Tight with 6', 14/3 So Cord w/NEMA Twist Lock 120V Plug and Integral Motion Sensor
SLVT-8-LB3-8CP3-MV-LVD-OS-CC6NTL120V	64509201-I	Sellado Series 8' Vapor Tight with 6', 14/3 So Cord w/NEMA Twist Lock 120V Plug and Integral Motion Sensor
SLVT-2-LB3-8CP3-MV-LVD-OS-CC6NTL277V	64507301-I	Sellado Series 2' Vapor Tight with 6', 14/3 So Cord w/NEMA Twist Lock 277V Plug and Integral Motion Sensor
SLVT-4-LB3-8CP3-MV-LVD-OS-CC6NTL277V	64508301-I	Sellado Series 4' Vapor Tight with 6', 14/3 So Cord w/NEMA Twist Lock 277V Plug and Integral Motion Sensor
SLVT-8-LB3-8CP3-MV-LVD-OS-CC6NTL277V	64509301-I	Sellado Series 8' Vapor Tight with 6', 14/3 So Cord w/NEMA Twist Lock 277V Plug and Integral Motion Sensor

REMOTE CONTROL OCCUPANCY PROGRAMMER ACCESSORY (Must Order Separately)

Catalog Part Number	Order Number	Description
SLVT-RCOP	70236101	Sellado Series Vapor Tight Remote Control Occupancy Programmer (Download Spec Sheet)



DIMENSIONS / DETAILS

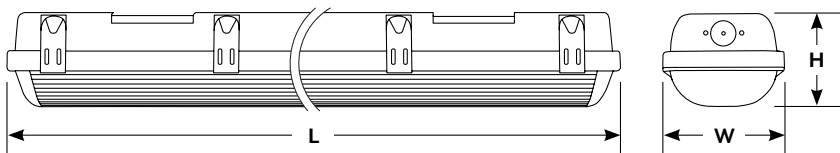

Size	L	W	H	weight
2'	23.6" (600 mm)	5.0" (125 mm)	3.7" (92 mm)	3.64 lbs.
4'	47.2" (1200 mm)	5.0" (125 mm)	3.7" (92 mm)	5.95 lbs.
8'	94.5" (2400 mm)	5.0" (125 mm)	3.9" (101 mm)	13.45 lbs.



Easy access to CCT & Wattage Select switch underneath lens

Ships at 3500K and highest wattage.

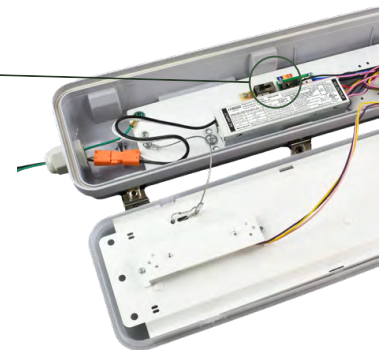

PERFORMANCE / Data

Lumen Maintenance

Ambient Temp.	TM-21 Lumen Maintenance (54,000 hours)
25° C (77° F)	> 87%
Ambient Temp.	TM-21 Theoretical L70 (hours)
25° C (77° F)	> 175,000

Load Information

Power Factor	> 0.90
THD	< 20%
Frequency	60 Hz
Low Temp Start / Max Temp	-4°F to 104°F (-20°C to 40°C)

DIMMER COMPATIBILITY LIST

DIMMER BRAND	DIMMER MODEL
0-10V DIMMERS	
LEVITON	DS710
LEVITON	DVTV
LUTRON	IP710
LUTRON	RH4FBL3PW
LUTRON	NTSTV-DV
LEGRAND	NFTV

PHOTOMETRIC SAMPLES

2-FT

Luminaire Data: at 4000K
SLVT-2-LB3-8CP3-MV-LVD

CCT & CRI	4000K, 80+ CRI
DELIVERED LUMENS	4365 3481 2680
WATTAGE	30.4 24.0 19.5
EFFICACY	144 145 137
SPACING	0° = 1.24 / 90° = 1.3

IES

Photometric values based on tests performed in compliance with LM-63 & LM-79

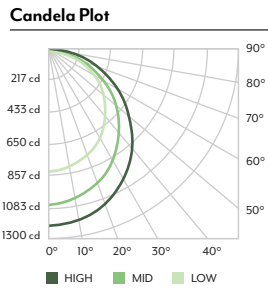

4-FT

Luminaire Data: at 4000K
SLVT-4-LB3-8CP3-MV-LVD

CCT & CRI	4000K, 80+ CRI
DELIVERED LUMENS	7008 4925 3523
WATTAGE	49.3 33.3 23.4
EFFICACY	142 148 151
SPACING	0° = 1.24 / 90° = 1.3

IES

Photometric values based on tests performed in compliance with LM-63 & LM-79

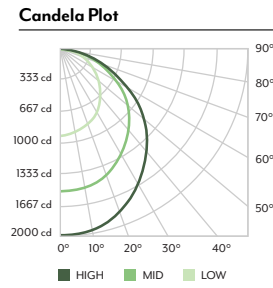

8-FT

Luminaire Data: at 4000K
SLVT-8-LB3-8CP3-MV-LVD

CCT & CRI	4000K, 80+ CRI
DELIVERED LUMENS	12404 10359 8711
WATTAGE	88.6 72.6 60.3
EFFICACY	140 143 144
SPACING	0° = 1.24 / 90° = 1.3

IES

Photometric values based on tests performed in compliance with LM-63 & LM-79

