



PRODUCT OVERVIEW

ETI Lighting's Century Series Flush Mounts feature a clean, modern design and flexibility for a variety of residential spaces. These integrated LED lights have **3 Color Preference®** field-selectable CCT options and a soft, comfortable light quality. They are 80+ CRI and have an L70 projection to 50,000 hours.

Integrated LED with diffused lens

Long Life: > 50,000 hours (L70)

3 CCT: 3000K, 4000K, 5000K | CRI: 80+

-4°F to 104°F (-20°C to 40°C)

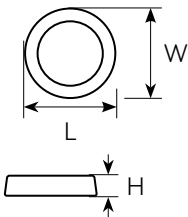

Model #	Description	Energy/Performance		Dimensions/Weights			
		Watts	Lumens	L	W	H	weight (lbs)
CO1171401A	14" Century	22	1600	14.0"	14.0"	3.2"	2.0
CO1172401A	16" Century	22	1800	16.0"	16.0"	3.4"	2.7

Series	Size (Dia.)	CRI	CCT	Voltage	Dim.	Finish
CTFM	14 (14")	8	CP3	SV	TD	WH
Century Flush Mount	16 (16")	80+ CRI	3 CCT	120V	TRIAC Dimming	White Finish

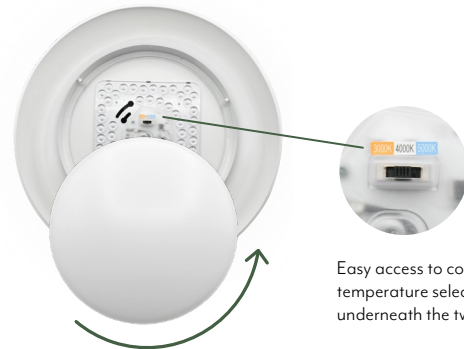

Easy access to color temperature select switch underneath the twist-off lens

